

# OPERATING AND INSTRUCTION MANUAL

---



## BOSS CHARGER

BC-1 | BC-2 | BC-5



KANAAD ELECTROMATION SOLUTIONS PVT.LTD.

# KNOW YOUR MACHINE



- Handel
- VRLA / ACID Battery selection Switch
- 7 Segment Display for Voltage
- Power ON/OFF Switch
- 7 Segment Display for Current
- LED indications
- Rotary knob for Current selection
- Connection for Battery -ve
- Connection for Battery +ve

## MODEL - BC1

- Size (mm):- 120(h)x165(w)x200(d)
- Weight:- 1.5Kg(approx.)



## MODEL - BC1

- Size (mm):- 120(h)x330(w)x200(d)
- Weight:- 3Kg(approx.)



## MODEL - BC5

- Size (mm):- 165(h)x555(w)x200(d)
- Weight:- 7Kg(approx.)

# HOW TO CHARGE BATTERY

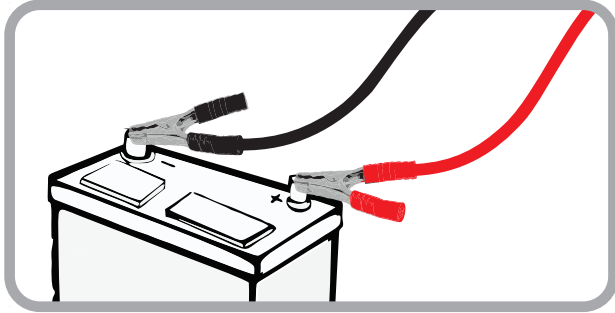

- Connect battery to charger with proper polarity.



- Plug mains input(230Vac).
- Select battery type ACID/VRLA.

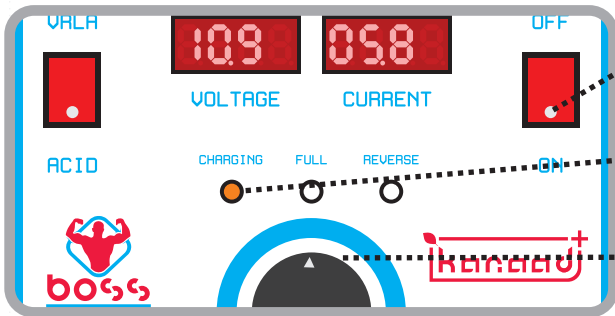

- Switch ON charger.
- Charger will show Charging indication.
- Set charging Current using selection knob.
- Charging current can be seen on Current display.

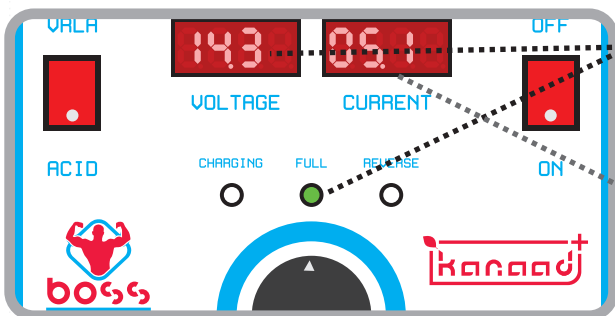

- When battery voltage reaches maximum charging voltage, charging FULL green indication will glow.
- Current will start dropping to maintain full voltage.

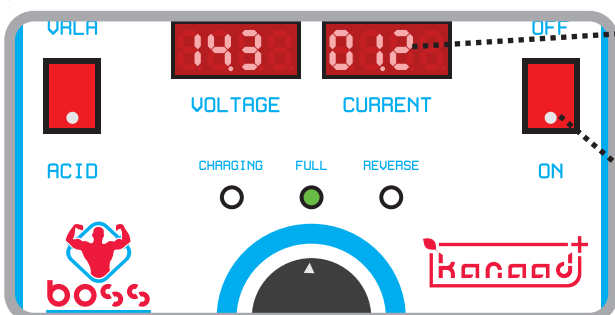

- Wait for current to drop substantially or for maximum of 1 hour.
- Switch OFF charger.
- Remove battery from charger.

## Specifications:-

- Input Voltage:- 230Vac(+/-15%) 50Hz
- Input Current:- 0.8A max
- Operating Temperature:- 0 to 85 Deg
- Charging Profile:- Constant Current Constant Voltage

## TROUBLESHOOTING

PROBLEM	CAUSE / FINDINGS
Charger does not start	<ul style="list-style-type: none"><li>• Check all input connections and supply.</li><li>• Check fuse blown indication.</li></ul>
Battery not charging	<ul style="list-style-type: none"><li>• Check all connections from battery to machine.</li><li>• Battery connection reversed.</li><li>• Wrong current/battery selection.</li></ul>
Charger showing Output Fault indication	<ul style="list-style-type: none"><li>• Battery connection not proper.</li><li>• Battery open/short.</li></ul>

### For Better Results:

- Make battery terminals clean and dry for proper contact.
- Confirm correct and tight connections.
- Select proper charging current

### Warning:

- Call company service for repairs and maintenance.
- Do not try repairs without any technical help from company service. This may lead to damage to person attending repairs / operator.

### Manufactured By:

**Kanaad Electromotion Solutions Pvt.Ltd.**

Joglekar Building, Opp. Hotel Lotus, Old Station Road,  
Azad Chowk, Sangli, (Maharashtra,India) - 416416.

Phone : 0233-6604871      E-mail : info@kanaad.com